

DESIGNED BY: AEL	REVISIONS		NUMBER	DATE	DESCRIPTION	NUMBER	DATE	DESCRIPTION
CHECKED BY: SCF	1	8/7/08			REVISED NOTES	4	12/12/08	INCORPORATE ALDERMEN & CITY COMMENTS
I:\eng\y077666\Plot\766CON01.dwg Dec 12, 2008	2	8/15/08			INCORPORATE COMMENTS - FINAL CONSTRUCTION PLANS			
FILE NAME: 766CON01.dwg	3	9/18/08			INCORPORATE CITY'S COMMENTS RE: TRAFFIC CABINET			

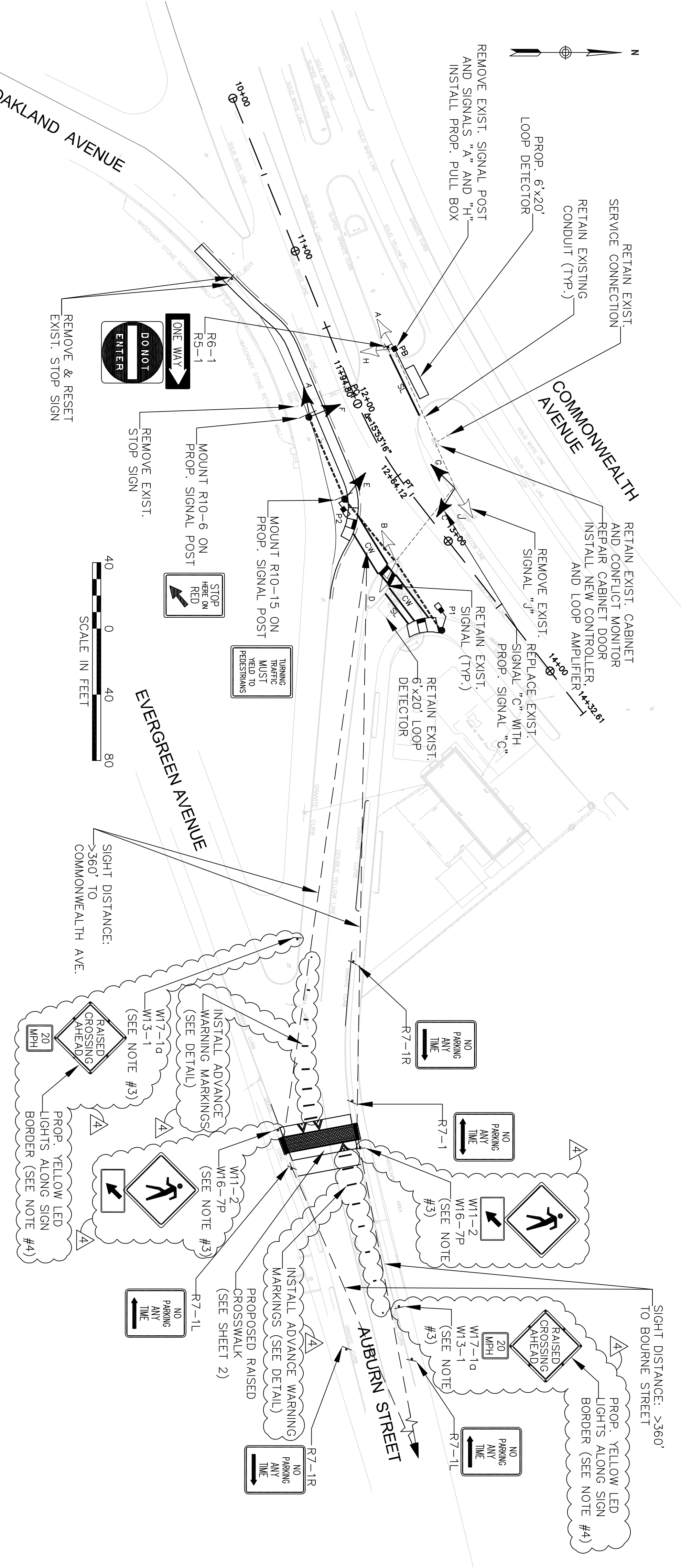

**SIGNAL NOTES:**

1. PROPOSED MODIFIED SIGNAL TIMINGS WILL BE COORDINATED WITH THE CITY TRAFFIC ENGINEER DURING CONSTRUCTION AND PROGRAMMED IN THE CONTROLLER PRIOR TO PROJECT COMPLETION.
2. NEW SIGNAL CABLE SHALL BE INSTALLED FOR ALL PROPOSED AND RETAINED SIGNAL EQUIPMENT.
3. ALL PROPOSED SIGNAL EQUIPMENT SHALL CONFORM TO MASSHIGHWAY AND CITY OF NEWTON STANDARDS.
4. LOCATION OF EXISTING CONDUIT IS APPROXIMATE AND HAS NOT BEEN VERIFIED. THE CONTRACTOR SHALL VERIFY THE LOCATION OF EXISTING CONDUIT IN THE FIELD.
5. THE CONTRACTOR SHALL BE RESPONSIBLE FOR REPLACEMENT OF THE EXISTING LOOP DETECTOR ON AUBURN STREET IF EXCAVATION RESULTS IN OPEN LOOP WIRE AND/OR LOSS OF DETECTION.

**LIST OF MAJOR ITEMS REQUIRED**

QUANTITY	DESCRIPTION
1	TS-2, TYPE 2, TRAFFIC CONTROLLER
1	DUAL CHANNEL LOOP AMPLIFIER (SHELF MOUNT)
2	PEDESTRIAN SIGNAL HEAD, 12" LED, SINGLE SECTION
5	SIGNAL HEAD, 3-SECTION, 12" LED
2	TRAFFIC SIGNAL POST & BASE STANDARD - 10' (STEEL)
2	TRAFFIC SIGNAL POST & BASE STANDARD - 8' (STEEL)
1	ELECTRIC PULL BOX - 12"x12"
1	SERVICE CONNECTION (OVERHEAD)

PLUS NECESSARY DUCT, CABLE, LABOR, MISCELLANEOUS MATERIAL AND EQUIPMENT TO COMPLETE THE INSTALLATION AND PROVIDE AN OPERATING TRAFFIC CONTROL SIGNAL.

**PROPOSED SIGNAL PHASING**

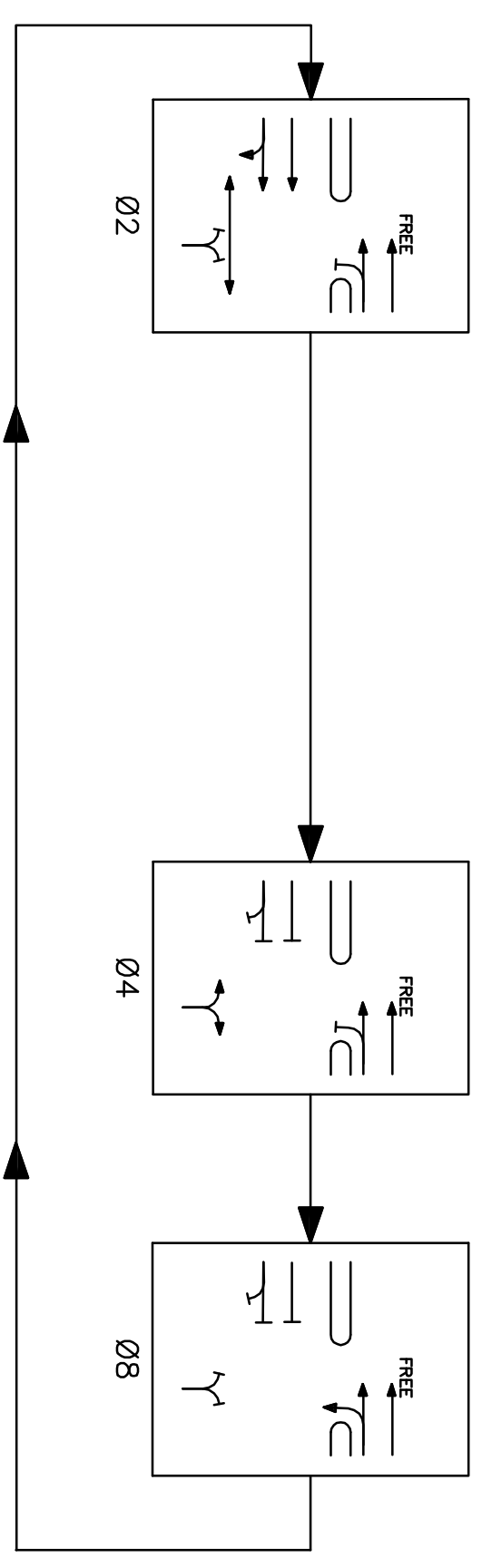

**LEGEND**

- EXISTING: Signal Head, Controller Cabinet, Pedestrian Signal Head, Signal Conduit, Signal Post, Loop Detector, Sign Post, Pull Box
- PROPOSED: Signal Head, Controller Cabinet, Pedestrian Signal Head, Signal Conduit, Signal Post, Loop Detector, Sign Post, Pull Box

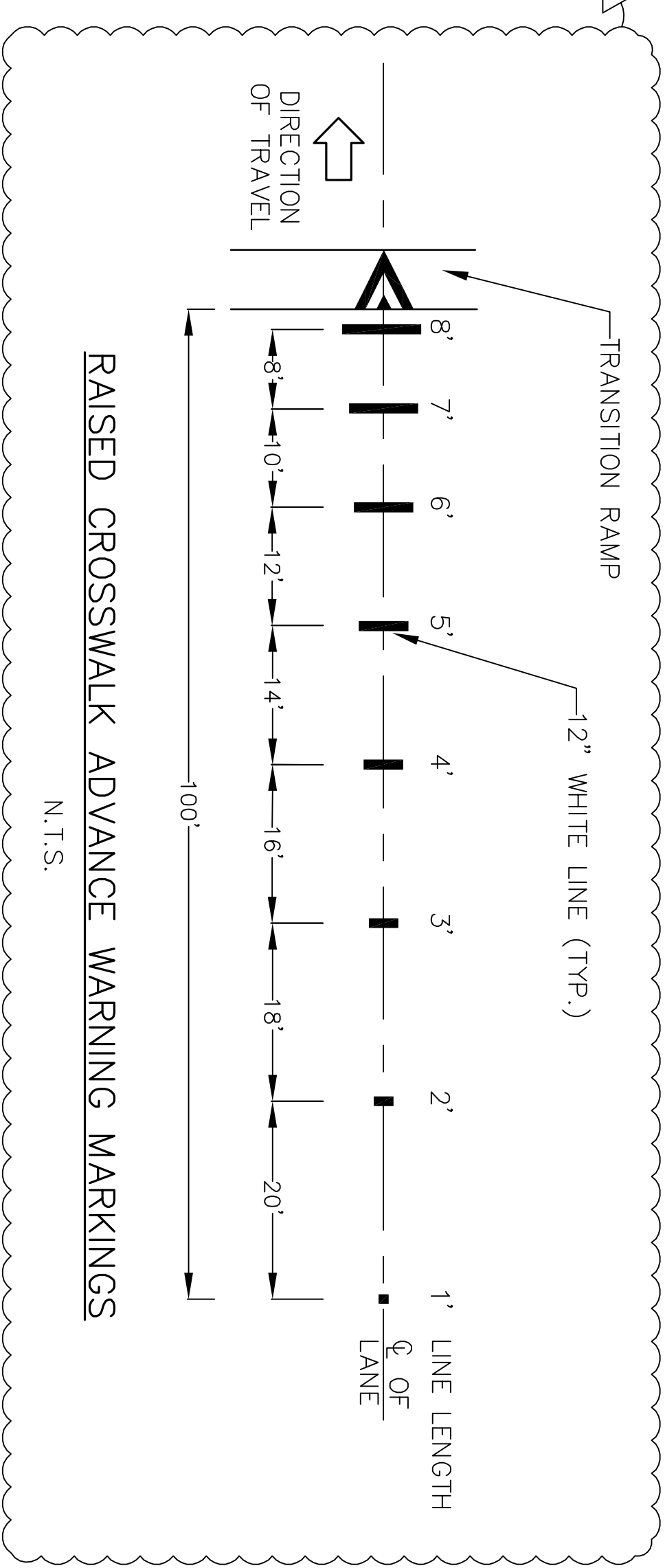

**NOTES:**

1. THE CITY OF NEWTON GENERAL CONSTRUCTION STANDARDS, THE 1988 MASSHIGHWAY STANDARD SPECIFICATIONS FOR HIGHWAY AND BRIDGES, THE SUPPLEMENTAL SPECIFICATIONS DATED JUNE 6, 2006, THE STANDARD SPECIAL PROVISIONS DATED NOVEMBER 20, 2007, THE 1977 CONSTRUCTION STANDARDS, THE APRIL 2003 METRIC/ENGLISH SUPPLEMENTAL DRAWINGS, THE 2003 "MANUAL ON UNIFORM TRAFFIC CONTROL DEVICES FOR STREETS AND HIGHWAYS", THE 1968 STANDARD DRAWINGS FOR TRAFFIC SIGNALS AND HIGHWAY LIGHTING, ALL CURRENT ENGINEERING DIRECTIVES, AND THE LATEST EDITION OF AMERICAN STANDARD FOR NURSERY STOCK WILL GOVERN.
2. PROPOSED PAVEMENT MARKINGS SHOULD BE EITHER THERMOPLASTIC OR EPOXY AND MEET MASSHIGHWAY SPECIFICATIONS.
3. PROPOSED W17-1g, W13-1, W11-2, AND W16-7P WARNING SIGNS SHALL BE FLOURESCENT YELLOW-GREEN, PER MASSHIGHWAY AND CITY OF NEWTON SPECIFICATIONS.
4. PROPOSED "RAISED CROSSING AHEAD" WARNING SIGNS SHALL HAVE INDIVIDUAL YELLOW LED UNITS ALONG THEIR BORDERS. THESE LED LIGHTS SHALL BE CONTINUOUSLY LIT WITHOUT FLASHING AND BE POWERED VIA A SOLAR PANEL. THESE SIGNS SHALL BE "BLINKERSIGNS" BRAND BY TAPCO, INC., OR APPROVED EQUIVALENT.



**COMMONWEALTH AVENUE (ROUTE 30) & AUBURN STREET**

**TRAFFIC PLAN**

Hess Corporation  
Newton, Massachusetts

SCALE: AS SHOWN	SHEET NO. 1	TOTAL SHEETS 4
DATE: 7/25/08		